

# Continuing Studies Building Addition

- Project Overview
- Engagement
- Variances
  - height
  - parking
- Transportation Management

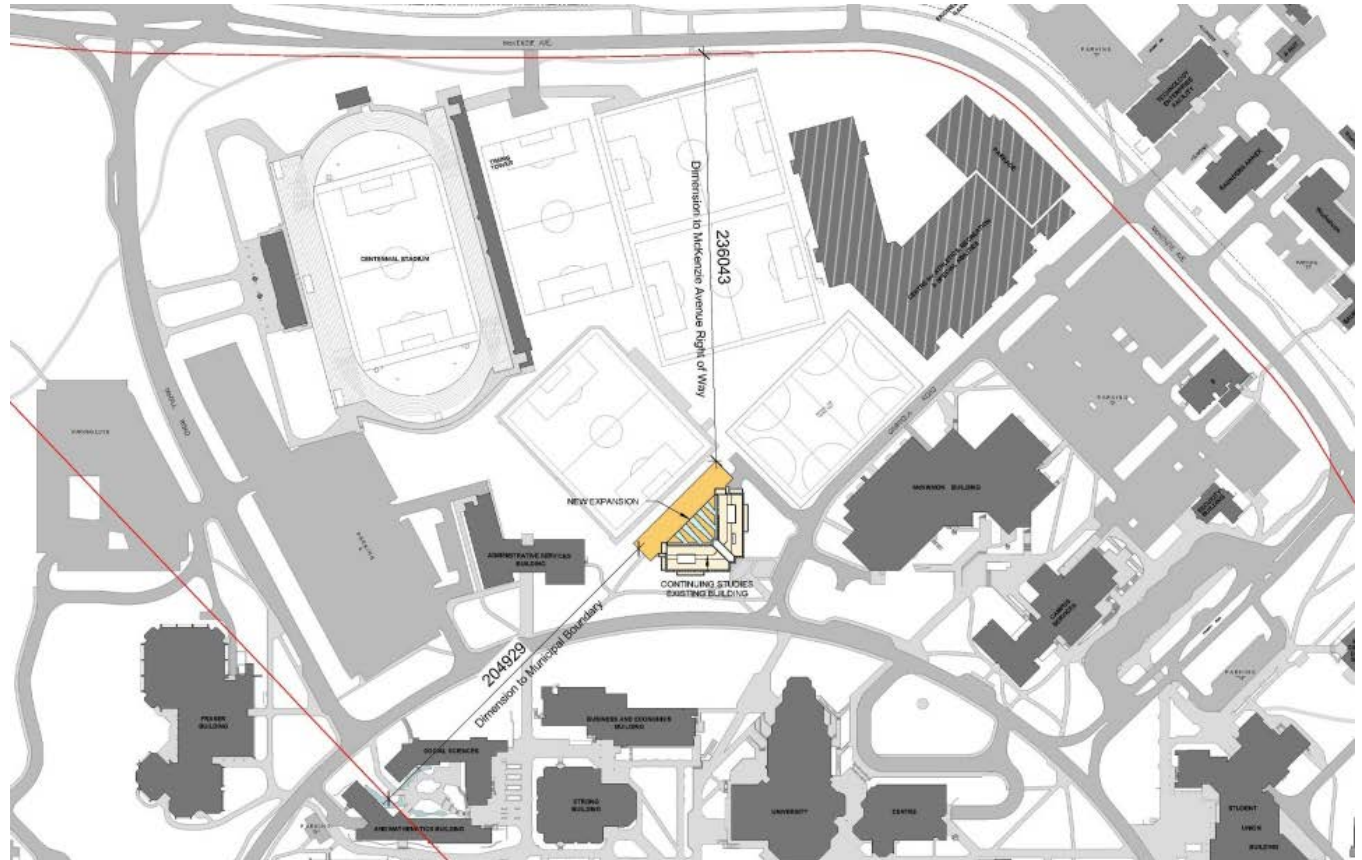

# Continuing Studies Building Addition

## Building

- Completed in 2003
- Lower level and 3 levels above grade
- 14.8m building height (2002 DVP)



## Addition

- Provides for Continuing Studies program expansion needs and Includes renovations
- Accommodates the English Language Centre and the Pathways Program
- Adds 13 new classrooms, computer language labs, 4 offices and student and instructor support space

## Engagement

- Framework
- Open House – Oct. 8/13
- Community Assoc. Liaison Committee



# Continuing Studies Building Addition

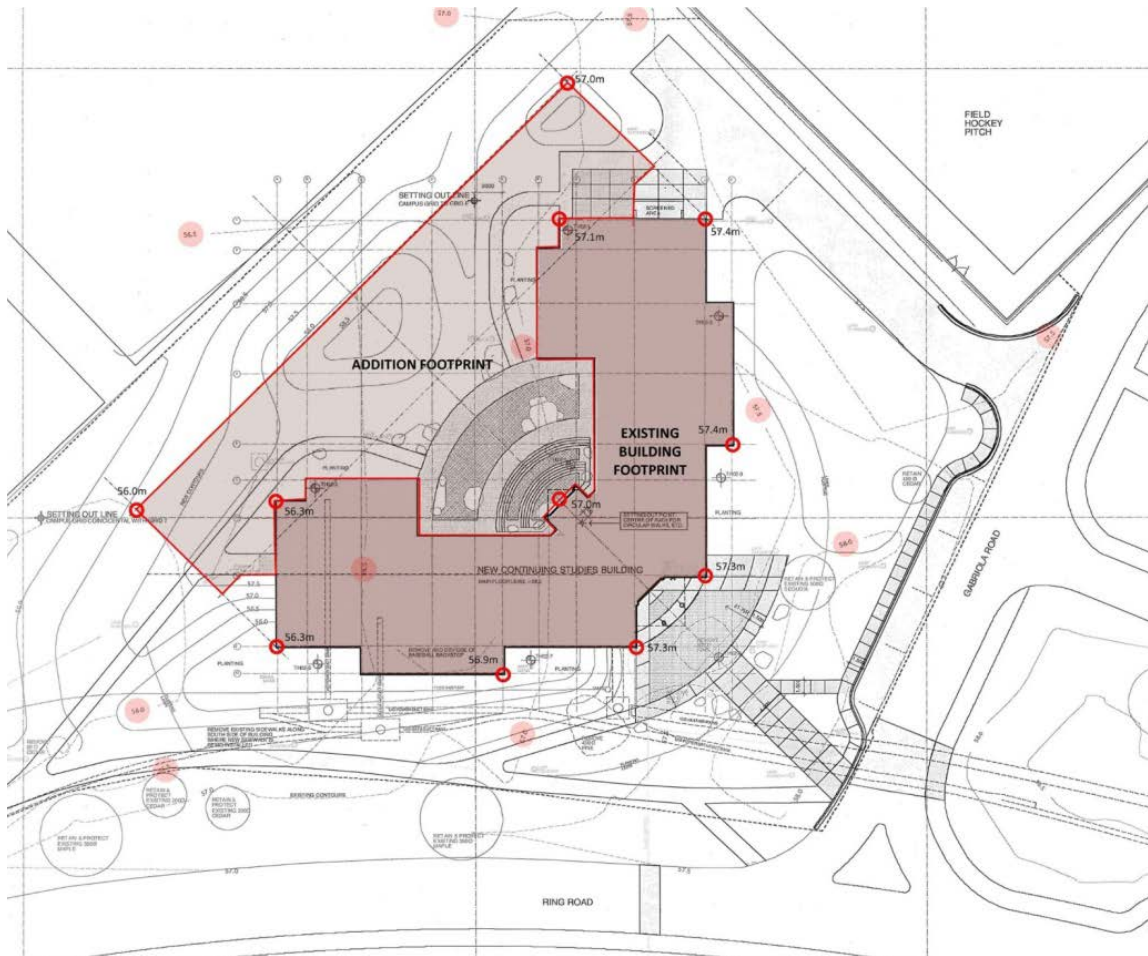

- 3130 m2 addition
- 13m height
- Lower level with two levels above grade
- Enclosed atrium
- Size, massing and exterior treatment to complement the existing building









# Continuing Studies Building Addition

## Parking Variance / Transportation Management

- Limited parking demands from international students
- Homestay program
- Transit, cycling and walking options
- Bike parking included in the project and at the nearby campus bike centre
- TDM program
- Parking management

